

# User Guide

# 用户手册

30W 单口百兆远距离防水 PoE 延长器

30W long-range waterproof PoE Extender

## Package Contents

Check the following contents of your package:

- PoE Extender x 1
- User Guide x 1
- Accessories ( water joint )

If any part is lost and damaged, please contact your local agent immediately.

## Introduction

This Product is a 10/100M IP67 long-range waterproof PoE extender independently developed by our company. It supports one RJ45 (PD) port in and 30W input. One port has PSE function, support up to 30W output, without configuration, plug and play.

Professional room shell design, adapted to various harsh environments, with high stability, reliability, industrial level, wide temperature. The whole machine does not need power adapter, so it is convenient for harsh outdoor environment .Reliable and convenient power for outdoor work AP, cameras etc.

## Product Features

- Complies with IEEE802.3af/at Standard;
- Plastic shell, protection level IP67;
- Complete unit does not require power adapter;
- PD Input , one PSE output;
- Data and power carried over the same cable;
- Support Plug-and-play for the devices without any configuration;
- Support 10/100Mbps data transmission;
- Delivers full POE Plus power at 300m;
- Unrestricted 10Mbps with POE at 800m;
- Operating temperature : -10°C~55°C;
- It's ideal for harsh outdoor environment;

## Hardware Description

### Front Panel

The front panel composed by PSE output port , input port, as shown below:

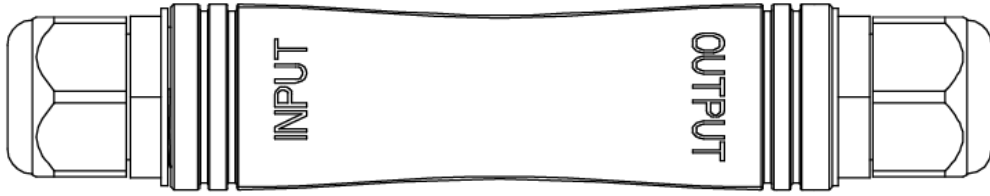

### Back Panel

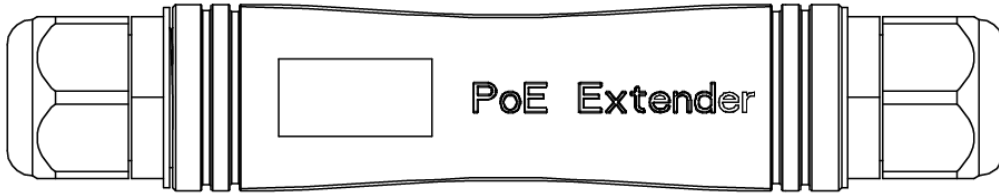

### Left Panel

Schematic diagram of left panel: input port (PoE In)

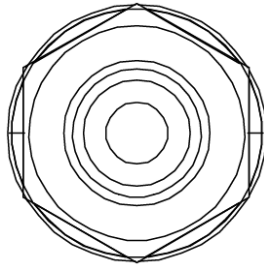

### Right Panel

Schematic diagram of left panel: output port ( PoE out )

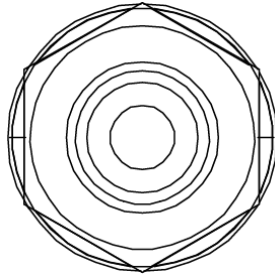

### Installation

This part describes how to install your machine and make connections to it. Please follow the following instructions in avoid of incorrect installation causing device damage and security threat.

- The nuts of the waterproof joint should be tightened in full fit with the joint's thread and fit to the hexagon plane, otherwise it is easy to get water and damage the machine;
- Do not place the machine on an unstable case or desk. The machine might be damaged severely in case of a fall;
- Make sure that the operating voltage is the same one labeled on the machine;
- Do not open the waterproof shell while the machine is working or not to avoid electrical shocks.

## Application diagram of PoE injector:

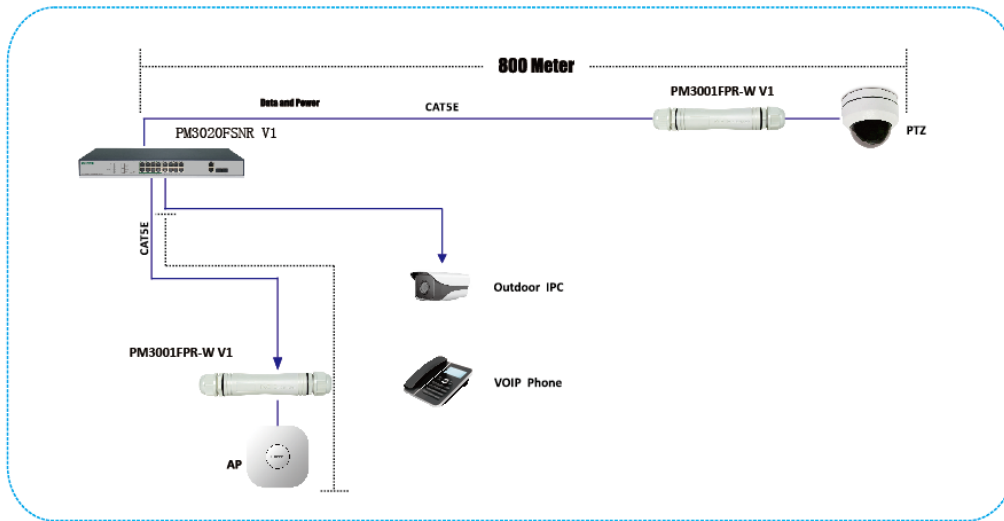

## Specifications

Model	30W long-range waterproof PoE Extender
Port	1*10/100Mbps RJ45 port 1 PD IN
Standard	IEEE802.3, IEEE802.3u, IEEE802.3af, IEEE802.3at, IEEE802.3x
Network Media(Cable)	10BASE-T: UTP category 3,4,5 cable (≤100m) 100BASE-TX: UTP category 5 cable (≤100m)
Dimensions (L*W*H)	156.5*29*29MM
PD port input	30W
PoE power output	48-55V DC Max.30W
PSE Power on RJ-45	Anode1/2 Cathode3/6 ,Anode4/5 Cathode7/8
Temperature	Operating Temperature:-10 ° C ~ 55 ° C Storage Temperature: -40 ° C ~ 70 ° C
Humidity	Operating Humidity: 10% ~ 90% non-condensing Storage Humidity: 5% ~ 90% non-condensing
Waterproof rate	IP67

## 包装清单

小心打开包装盒，包装盒内应有以下物件：

远距离延长器..... 一台  
用户手册 .....一本  
安装附件（2 个防水接头）

如果发现有物件损坏或者短缺的情况，请及时和当地经销商联系。

## 产品简介

此产品是我司自主研发的单口百兆远距离防水 PoE 延长器，支持 1 个 RJ45( PD )端口进，PD 支持最大 30W 输入(端口具有 PSE 功能，支持最大 30W 输出，无需配置，即插即用。

专业室外壳体设计，适应各种恶劣环境，具有高稳定性，可靠性，工业级水平，宽温度。整机不需要电源适配器，方便恶劣的户外环境及户内不容易取电的监控设备。

## 性能特征

- 支持 IEEE802.3at 标准，兼容 IEEE802.3af 的受电设备（PD）；
- 塑胶外壳，防护等级 IP67；
- 能在一条网线上同时传输数据和电力；
- 支持 10/100Mbps 数据传输；
- 100Mbps 数据传输及 PoE 供电距离高达 300M；
- 10Mbps 数据传输及 PoE 供电距离高达 800M；
- 1 个 PD 受电端；
- 1 个 PSE 供电端；
- 即插即用，无需配置；
- 高稳定设计，确保设备远距离所需的电源和带宽；
- 工作温度：-10°C ~55°C；
- 专业室外壳体设计，适应各种恶劣环境；

## 外观描述

### 正面

正面由 PSE 输出端口跟输入端口组成，如下图所示：

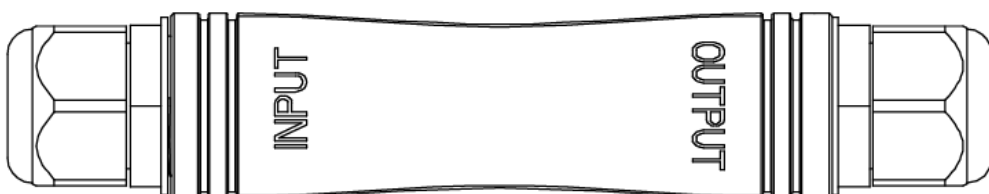

背面

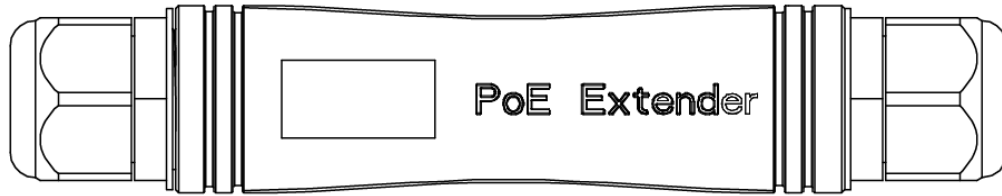

左面

左面板示意图:输入端口 ( PoE In )

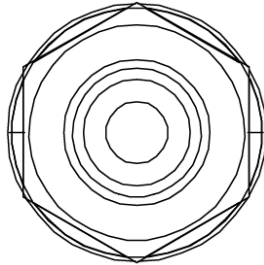

右面

右面板示意图: 输出端口 ( PoE out )

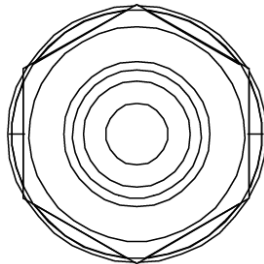

## 安装设备

### 注意事项

为避免使用不当造成设备损坏及对人身伤害，请遵从以下的注意事项：

- 防水接头螺帽需跟接头螺纹完全配合拧紧，贴合六角平面，否则易导致进水，损坏机器；
- 请不要将机器放在不稳定的箱子或桌子上，万一跌落，会对机器造成严重损害；
- 机器要在正确的电压下才能正常工作，请确认工作电压同机器所标示的电压相符；
- 为减少受电击的危险，在机器工作时不要打开外壳，即使在不带电的情况下，也不要随意打开机壳；

应用拓扑示意图：

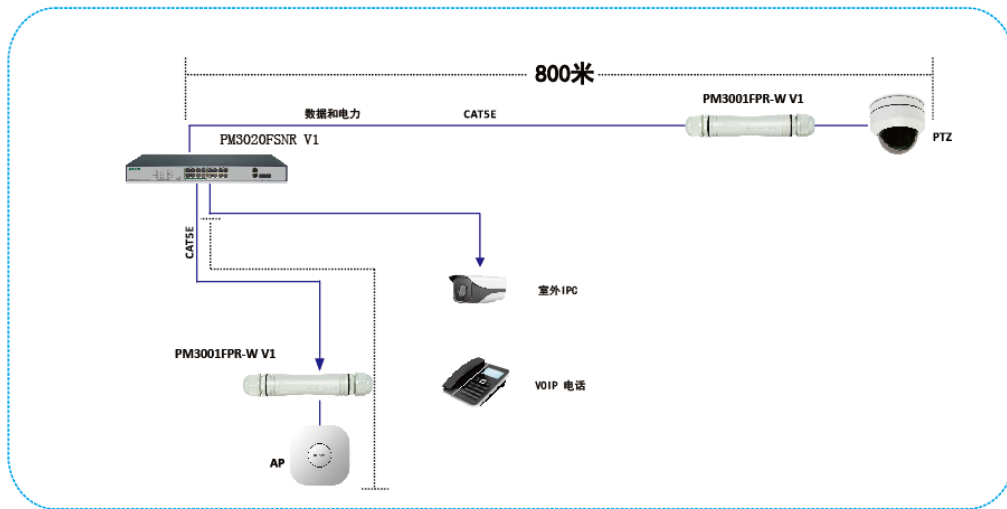

### 技术规格

产品名	30W 单口百兆远距离防水 PoE 延长器
端口	1 个 10/100Mbps RJ45 口 1 个 PD IN
标准	IEEE802.3, IEEE802.3u, IEEE802.3af, IEEE802.3at, IEEE802.3x
网络介质 ( 线缆 )	10BASE-T: Cat 3,4,5 非屏蔽类双绞线(≤100m) 100BASE-TX: Cat 5 及以上非屏蔽类双绞线(≤100m)
尺寸(长*宽*高)	156.5*29*29MM
PD 端口输入	30W
PoE 端口输出	每个 PoE 端口输出 48-55V DC Max.30W
PoE 供电线对	1/2+、3/6-线对 ,4/5+、7/8-线对
工作温度	-10°C ~55°C
存储温度	-40 °C ~ 70 °C
工作湿度	10% ~ 90% 无凝结
存储湿度	5% ~ 90% 无凝结
防水等级	IP67