

2D imaging through wall radar

AT-TWR-2D-M

Features

- Similar in size to a laptop, the AT-TWR-2D-M allows for maximum flexibility and maneuverability in any type of urban mission.
- Optimized design for tactical tasks, small and light;
- Can reliably detect people behind most common walls;
- Two-dimensional imaging capability enables intuitive image interpretation;
- Simultaneous detection of stationary and moving targets;
- Only minimal training requirements;
- Support multiple devices to work at the same time without interfering with each other
- Inexpensive and easy to use.

Application

- hostage rescue
- Action against Terrorism
- urban warfare
- intelligence gathering
- Reconnaissance and surveillance
- dangerous catch
- Anti-drug operation
- search and rescue operations

Description

Tactical teams conducting urban operations are often challenged entering unknown environments, Optosky's Compact through wall imaging radar AT-TWR-2D-M quick location of people hidden by walls and barriers, enabling tactical teams to step into the known and obtain mission-critical information.

The AT-TWR-2D-M is a compact, lightweight and durable personal device optimized for speed of tactical entry, providing Special Forces and Search and Rescue forces with critical information on the number and location of personnel behind walls in real time. Because of its simple operation, AT-TWR-2D-M provide key information for combat missions at any time and place needed.

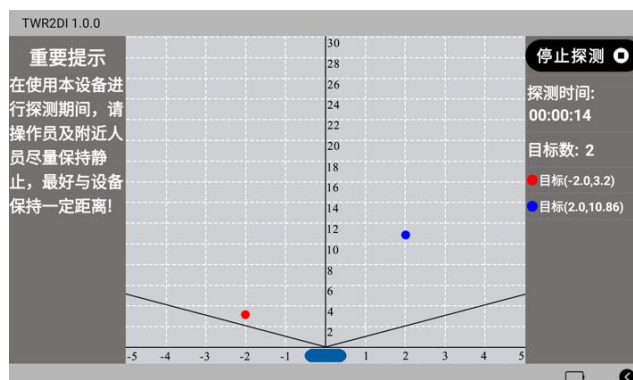
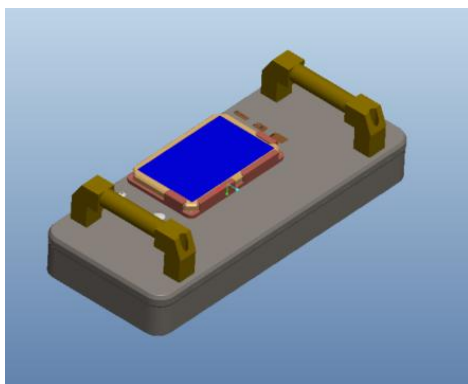

1. Technical indicators

Equipment type	Compact Through Wall Imaging Radar
Penetrable wall material	Various common walls
Penetration	Not less than two 30cm ordinary brick walls
Maximum detection distance	Not less than 30m
field of view	90 degrees both horizontally and vertically
display mode	2D plan view
resolution	The distance is better than 0.3m, and the azimuth is 1m@5m
size	40×25×15cm
weight	6kg (including battery)
Power	Replaceable 18650 lithium battery, can be charged with an external adapter
battery working time	about 4 hours
Dustproof and waterproof	IP65

2. advanced technology

AT-TWR-2D-M uses the latest system structure, including a number of cutting-edge technologies. An ultra-wideband (UWB) stepped frequency (SF) multiple-input, multiple-receive (MIMO) sensor ensures reliable detection and industry-leading object resolution. Advanced image reconstruction algorithms can effectively suppress environmental clutter and produce high-quality intuitive images. Ease of operation and compactness are key features of the design.

AT-TWR-2D-M has remote wireless control capability, and the operator can control it covertly to ensure personal safety. Images can also be transmitted to a remote server or commander, facilitating command decisions.